

Install Motor Box onto Pedestal Bracket

1. Fasten the slotted motor box mounting bracket to the bottom of pedestal bracket using the four #10 fasteners and any needed shims.

If a shim is needed for aligning the belt with the wheel, the thickness is based on the clearance distance between your spokes and pedestal (measured 5" / 127mm out from the center of your wheel).

2. Mount the motor box onto the slotted bracket using the carriage bolt, plastic washer and wing-nut. Snug the carriage bolts in the center position in the slots.
3. Hang assembly from belt and hose-clamp to pedestal. Place the drive pulley of the motor box in the belt, and allow the box and bracket assembly to hang in the belt and rest snug against the pedestal while you support it.

Align belt with wheel and tighten hose-clamps

1. Attach the adhesive foam pads to the hose-clamps, not the pedestal. Pass the hose-clamps through the slots from the inside of the bracket (start from the side with the 2 holes), around the pedestal and loosely tighten.
2. Adjust the clearance from the pedestal:
 - For the **Deep Pedestal Bracket**, the belt should align with the wheel when the edge of the stainless bracket is 2 1/2" (64mm) from most pedestals using any required shims; see clearance chart below.
 - For the **Shallow Pedestal Bracket**, the belt should align with the wheel when the edge of the stainless bracket is 1" (25mm) from most pedestals using any required shims; see clearance chart below.
3. Temporarily tighten the hose-clamps enough to hold the assembly in position.
4. Check for alignment: hold a yardstick or straight-edge against the back of the wheel adapter; it should be fairly parallel with the belt when viewed from the side (clutch engaged; pushed in). Also look from above the wheel and from the side to be sure the motor box is square with the wheel from all directions and not at an angle. If the belt is not parallel you can squeeze the stainless bracket deeper or shallower onto the pedestal as needed, or add or remove a shim. If in doubt or your wheel is not uniform, favor the motor box being closer to the pedestal (rather than farther). The slight belt slant will pull the clutch in which will help keep the clutch engaged.

Shallow Pedestal Bracket

Spoke-to-pedestal clearance	Shim Thickness	Bracket edge to pedestal
<input type="checkbox"/> 2.25" (57mm)	0 (no shim)	0.75" (1.9mm)
<input type="checkbox"/> 2.5" (64mm)	0 (no shim)	1" (2.5mm)
<input type="checkbox"/> 2.625" (67mm)	.125" shim (3mm)	1" (2.5mm)
<input type="checkbox"/> 2.75" (70mm)	0.25" shim (6mm)	1" (2.5mm)
<input type="checkbox"/> 2.875" (73mm)	.375" shim (10mm)	1" (2.5mm)
<input type="checkbox"/> 3" (76mm)	0.5" shim (13mm)	1" (2.5mm)
<input type="checkbox"/> 3.125" (79mm)	.625" shim (16mm)	1" (2.5mm)
<input type="checkbox"/> 3.25" (83mm)	0.75" shim (19mm)	1" (2.5mm)
<input type="checkbox"/> 3.375" (86mm)	0.875" shim (22mm)	1" (2.5mm)
<input type="checkbox"/> 3.5" (89mm)	1" shim (25mm)	1" (2.5mm)

Deep Pedestal Bracket

Spoke-to-pedestal clearance	Shim Thickness	Bracket edge to pedestal
<input type="checkbox"/> 3.75" (95mm)	0 (no shim)	2.25" (5.7mm)
<input type="checkbox"/> 4" (102mm)	0 (no shim)	2.5" (6.4mm)
<input type="checkbox"/> 4.125" (105mm)	0.125" shim (3mm)	2.5" (6.4mm)
<input type="checkbox"/> 4.25" (108mm)	0.25" shim (6mm)	2.5" (6.4mm)
<input type="checkbox"/> 4.375" (111mm)	.375" shim (10mm)	2.5" (6.4mm)
<input type="checkbox"/> 4.5" (114mm)	0.5" shim (13mm)	2.5" (6.4mm)
<input type="checkbox"/> 4.625" (117mm)	.625" shim (16mm)	2.5" (6.4mm)
<input type="checkbox"/> 4.75" (121mm)	0.75" shim (19mm)	2.5" (6.4mm)
<input type="checkbox"/> 4.875" (124mm)	.875" shim (22mm)	2.5" (6.4mm)
<input type="checkbox"/> 5" (127mm)	1" shim (25mm)	2.5" (6.4mm)

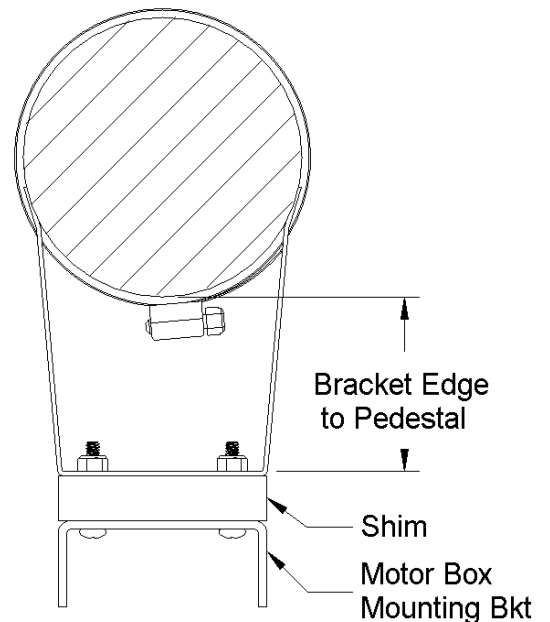

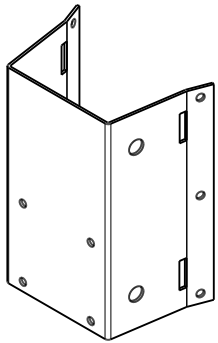

Shallow Bracket

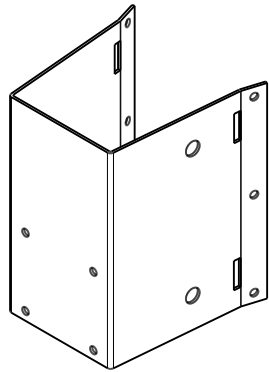

Deep Bracket

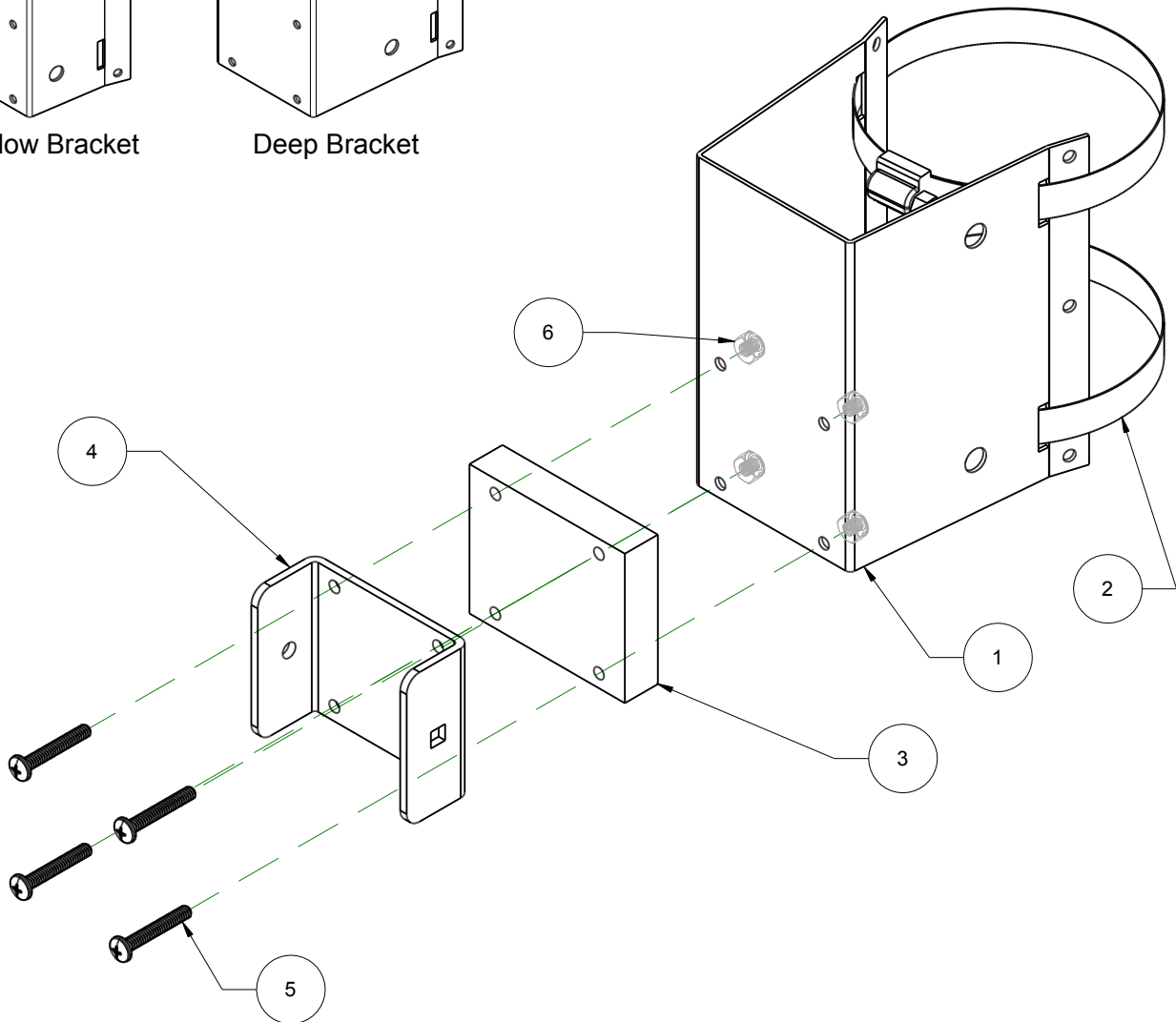

Item #	Quantity	Part Name	Comment
1	1	Pedestal Bracket	
2	2	Hose Clamp	Apply adhesive foam pads to hose clamps
3	1	Shim	Thickness based on clearance distance between spokes and pedestal
4	1	Motor Box Mounting Bracket, Outside	Note square hole for carriage bolt
5	4	10-24 Pan Head Machine Screw	
6	4	10-24 Nut	