

Motor Box Mounting Diagram

Union Polaris
 L-Bracket to Starboard Sidewall
 Vertical Motor Box
 Standard Motor Rotation
 Wheel Pulley Mounted to Aft Surface of Wheel

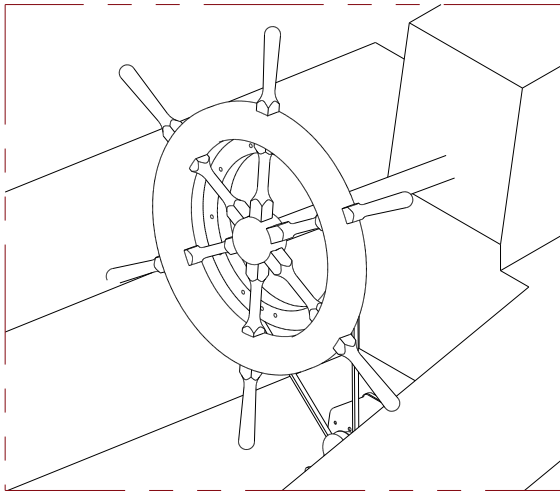

Notes:

1. Angled shim needed for mounting L-bracket (or bend L-bracket to match cockpit sidewall angle).
2. Tilt motor box and L-bracket to match wheel shaft angle.
3. Drive pulley within wheel perimeter. 1" spoke spacers used to keep pulley from hitting wheel handles when disengaged for hand steering.
4. Motor box mounted on port side to gain more clearance from deck.
5. See page 2 for belt and pulley detail.

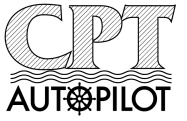

All dim. in inches

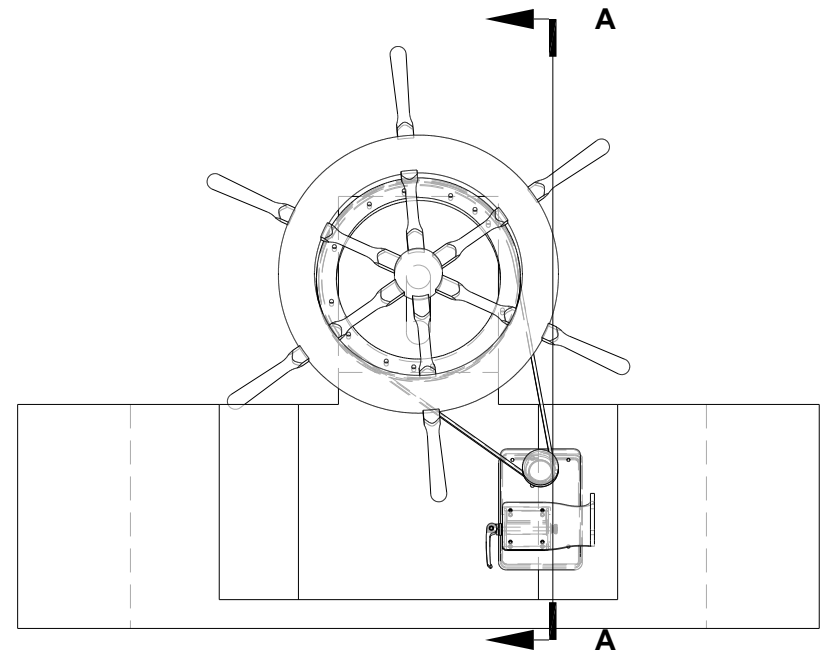
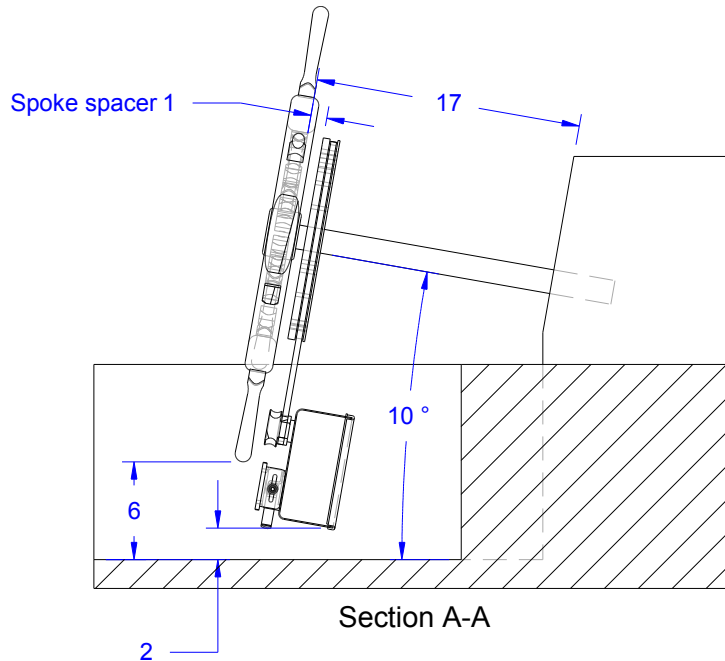
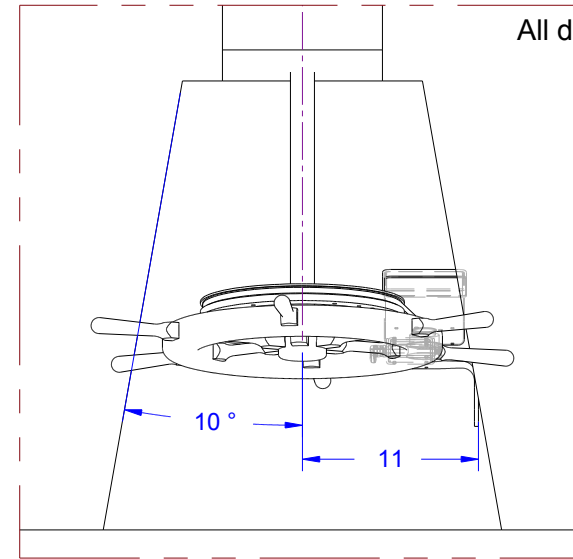

SCALE 1:12

Motor Box Mounting Diagram

Union Polaris
Wheel pulley and belt detail

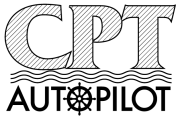

All dimensions in inches

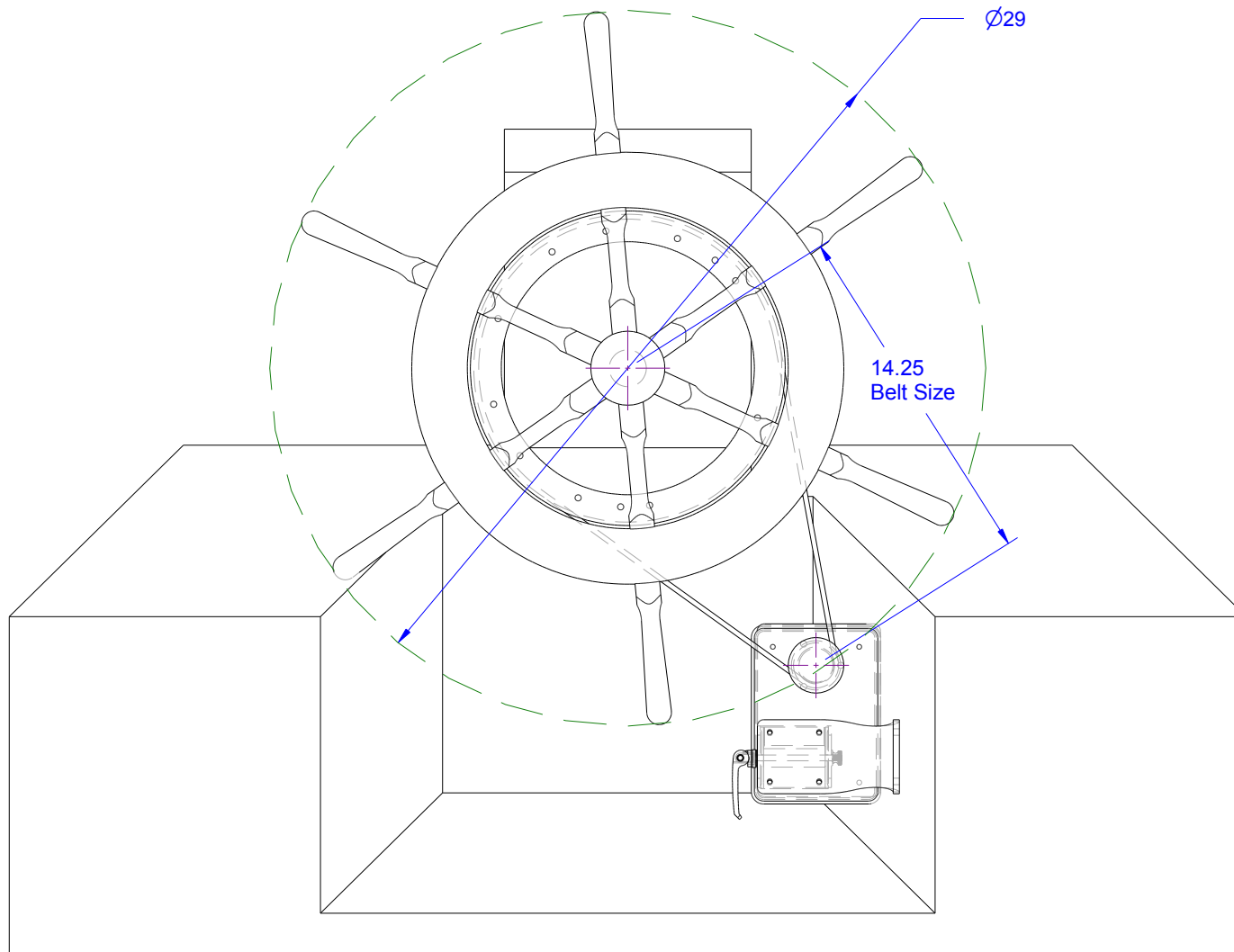

SCALE 1:7